

Population

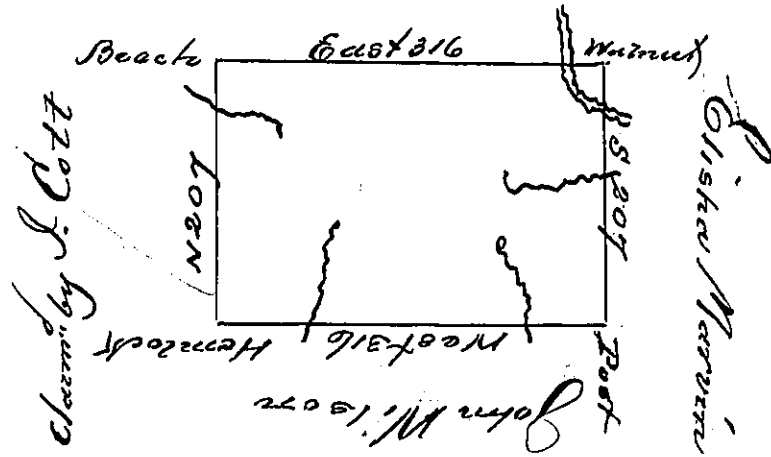

A draught of a tract of land in Greenfield Township Erie County on the waters of French Creek, surveyed the 14<sup>th</sup> of Nov<sup>r</sup> 1801, for Joseph Berry, by virtue of his actual settlement residence & improvement, containing three hundred & eighty five acres & sixty six perches, and more or less. Improved the 16<sup>th</sup> day of Oct<sup>r</sup> 1801, on default of

John Cochran D. J.

Erie County, U.S.

I hereby certify that the foregoing draught & entry is a true & correct copy of a draught of land and entry thereof made in the survey book of County aforesaid by John Cochran Esq. a former Dep<sup>y</sup> Surveyor of said County. And from the Survey Book it does not appear that the said tract of land is claimed by any one except the said Joseph Berry.

Witness my hand and seal the 8<sup>th</sup> day of Feby 1837.

Stephen Skinner  
D. J.

John Taylor Esq.  
J. G.

IN TESTIMONY that the above is a copy of the original remaining on file in the Department of Internal Affairs of Pennsylvania, made conformably to an Act of Assembly approved the 16th day of February, 1833, I have hereunto set my Hand and caused the Seal of said Department to be affixed at Harrisburg, this second day of June, 1903

Luca R. Brown  
Secretary of Internal Affairs.